

KRISS³ 8,5

PELLET AIR - Pellet stoves

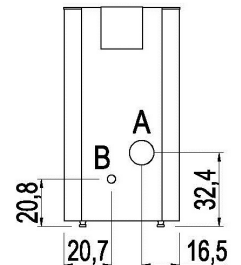

Nominal power	kW	8,6
Reduced power	kW	2,4
Introduced thermal power (max)	kW	9,73
Nominal water useful power	kW	-
Reduced water useful power	kW	-
Nominal efficiency	%	89,1
Reduced efficiency	%	92,9
Heating volume (min-max)	m ³	58 - 206
Nominal CO at 13% O ₂	%	0,006
Reduced CO at 13% O ₂	%	0,022
Emissions CO (13% O ₂) (min-max)	mg/Nm ³	274 - 79
Emissions OGC (13% O ₂) (min-max)	mg/Nm ³	3,9 - 1,5
Emissions NOX (13% O ₂) (min-max)	mg/Nm ³	104 - 136
Dust content at 13% O ₂ (min-max)	mg/Nm ³	19,3 - 14
Boiler capacity (H ₂ O)	l	-
Hopper capacity	kg	18
Combustible		Pellet ø6
Hourly consumption (min-max)	kg/h	0,53 - 2,01
Autonomy (min-max)	h	9 - 34
Ignition electrical absorption (max)	W	346
Operating electrical absorption (max)	W	76
Supply and frequency	V - Hz	230 - 50
Chimney flue depression	Pa	11,6
Exhaust diameter	mm	80
Combustion air inlet diameter	mm	60
Mass of smoke (min-max)	g/sec	2,2 - 4,8
Exhaust fumes temperature (max)	°C	196,6
Net weight	kg	79
Gross weight	kg	88
Exhaust fumes	see	A
Hole combustion air inlet	see	B
Ducting outlet	see	-
Ducting capability up to	m	-

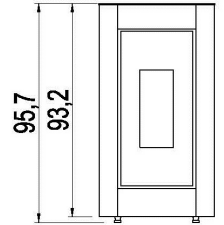
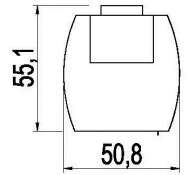

Art. 15A B-VG 2015
BImSchV 2016
Regensburg
München
Stuttgart
Aachen



MATCH

7015035		Anthracite steel	EAN 8033123616607
7015036		White steel	EAN 8033123616614
7015034		Light bronze steel	EAN 8033123616591
7015033		Red steel	EAN 8033123616584

PLUS



Cast iron burning pot



Sealed chamber



Aluminium Auger



Connection to the room thermostat



Comfort mode



Back exhaust



Wi-Fi kit (optional)



Cast iron door



Daily weekly programming



Remote control

STOVE PACKING

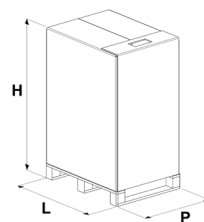

L (cm)	H (cm)	P (cm)
80	114,3	60

VOLUME (m ³)	0,55
--------------------------	------

LINING PACKING

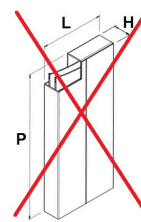

L (cm)	H (cm)	P (cm)
-	-	-

STOCKING

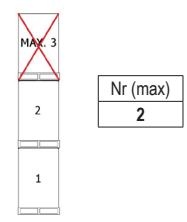

TRANSPORT

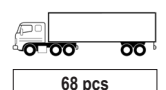

68 pcs