

MITHOS³ PLUS 12

PELLET AIR PLUS - Pellet stoves

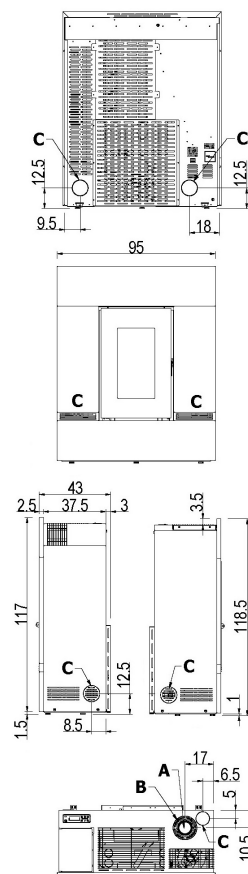

Nominal power	kW	12
Reduced power	kW	3,8
Introduced thermal power (max)	kW	13,3
Nominal water useful power	kW	-
Reduced water useful power	kW	-
Nominal efficiency	%	90
Reduced efficiency	%	93,5
Heating volume (min-max)	m ³	91 - 288
Nominal CO at 13% O ₂	%	0,0142
Reduced CO at 13% O ₂	%	0,0149
Emissions CO (13% O ₂) (min-max)	mg/Nm ³	186 - 177
Emissions OGC (13% O ₂) (min-max)	mg/Nm ³	3 - 3
Emissions NOX (13% O ₂) (min-max)	mg/Nm ³	109 - 114
Dust content at 13% O ₂ (min-max)	mg/Nm ³	19 - 14
Boiler capacity (H ₂ O)	l	-
Hopper capacity	kg	23
Combustible		Pellet ø6
Hourly consumption (min-max)	kg/h	0,86 - 3
Autonomy (min-max)	h	8 - 27
Ignition electrical absorption (max)	W	360
Operating electrical absorption (max)	W	151
Supply and frequency	V - Hz	230 - 50
Chimney flue depression	Pa	10
Exhaust diameter	mm	80
Combustion air inlet diameter	mm	60
Mass of smoke (min-max)	g/sec	3,9 - 8,1
Exhaust fumes temperature (max)	°C	185
Net weight	kg	165
Gross weight	kg	180
Exhaust fumes	see	A
Hole combustion air inlet	see	B
Ducting outlet	see	C
Ducting capability up to	m	8



MATCH

7021034	NEUTRAL STRUCTURE	EAN 8053859013501
6921027	White steel	EAN 8053859014102
6921028	Red steel	EAN 8053859014119
6921029	Anthracite steel	EAN 8053859014126
6921030	Steel light bronze	EAN 8053859014133
6921031	Steel titanium	EAN 8053859014140

PLUS

	Cast iron burning pot		Sealed chamber		Ducting with 2 independent motors
	Integrated Wi-Fi		Bluetooth		Comfort mode
	Upper exhaust		Concentric flue kit		Cast iron door
	Daily weekly programming		Connection to the room thermostat		5 sides ducting
	Cast iron inner with 2nd combustion air				

STOVE PACKING

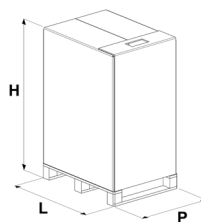

L (cm)	H (cm)	P (cm)
80	132,3	102

VOLUME (m ³)
1,0

LINING PACKING

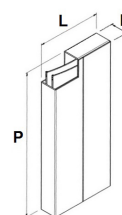

L (cm)	H (cm)	P (cm)	
steel	59	12,5	109,2

STOCKING

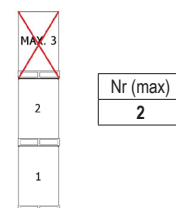

TRANSPORT

